

Data sheet

Commercial Art.No.: 70.350.0635.0

hood BAS GOT GG 6 M20 A0

Hood revos basic made of aluminum, for single locking lever with cable gland M20 on the right side (IP54), low version, 6-poles



| | |
|--------------------|---------------|
| Commercial Art.No. | 70.350.0635.0 |
| EAN | 4015573616813 |
| Order Unit | 1 |

certificates / approvals



Technical data

general

| | |
|--|---------------------|
| housing material | aluminum |
| color | grey |
| surface | with powder coating |
| degree of protection (IP) | IP54 |
| UV resistant | yes |
| flammability class of insulation material acc. with UL94 | other |
| operating temperature range min. | -40 °C |
| operating temperature range max. | 120 °C |

model

| | |
|------------------------|----------------------|
| construction | 6 |
| model of the housing | male |
| locking mechanism | single locking lever |
| cable entry | sideways |
| type of cable | gland nut |
| with cable screw gland | yes |
| thread size M | 20 |
| thread size PG | |
| hinged lid | no |
| EMC-version | no |
| length | 73.6 mm |
| width | 43 mm |
| height | 51 mm |

classification

| | |
|------------|----------|
| ECLASS 11 | |
| ECLASS 8.1 | 27440202 |
| ETIM 9.0 | EC000437 |
| ETIM 8.0 | EC000437 |
| ETIM 7.0 | EC000437 |
| ETIM 6.0 | EC000437 |
| ETIM 5.0 | EC000437 |
| ETIM 4.0 | EC000437 |
| ETIM 3.0 | EC000437 |

product compliance

| | |
|------------------------------|--------------------|
| ROHS conformity status | compliant/exempted |
| ROHS exceptions | III-6(c) |
| REACH-SVHC conformity status | Duty-To-Declare |
| REACH-SVHC substances | Lead |
| REACH-SVHC CAS numbers | 7439-92-1 |

These dimensions will be especially checked at delivery
 Only inspection dimensions
 With /E marked dimensions are only valid for internal use

Diese Maße werden bei Abnahme besonders geprüft
 Ausschließlich Prüfmaße
 Mit /E gekennzeichnete Maße sind nur für interne Zwecke gültig

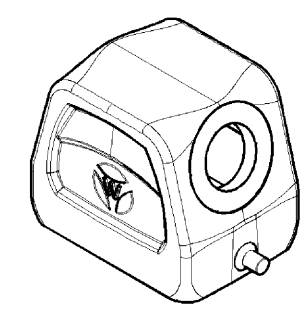
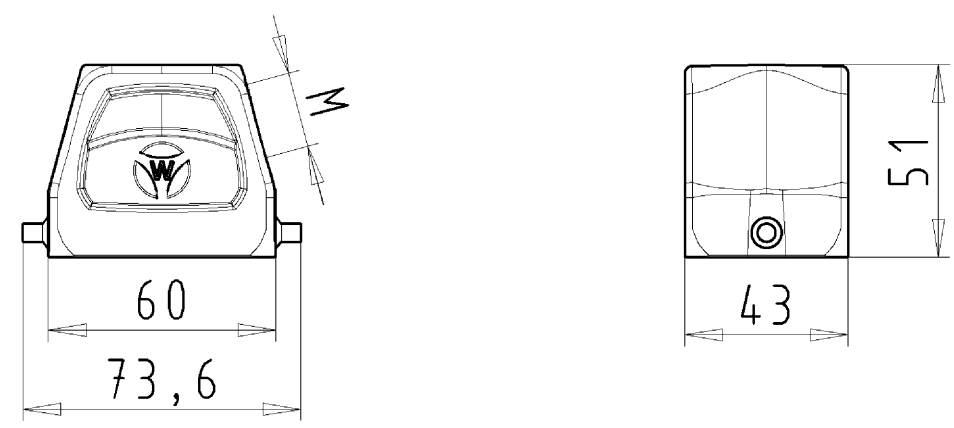

Varianten/ Variants

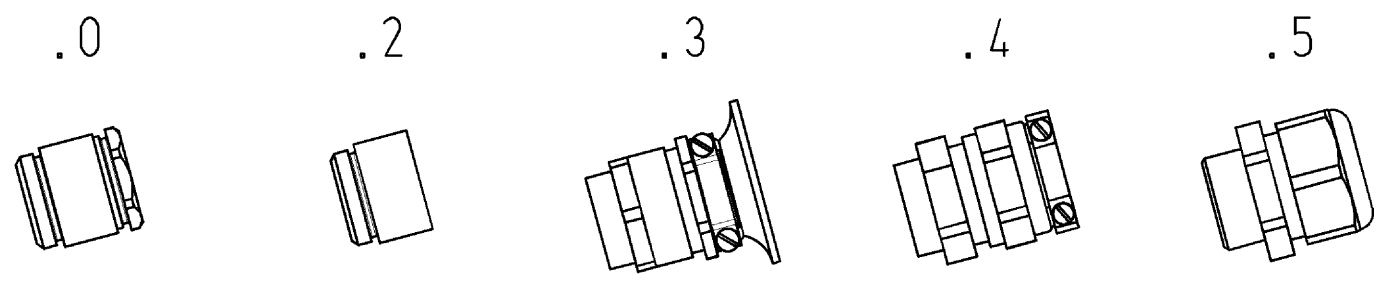

| | | | |
|---|--------------------------|--|----------------------|
| 70.35 ³ ₀ .0635.5 | BAS GOT GG 6 M25 M20 A 5 | Kabelverschraubung(KV), IP65 /Cable gland(CG), IP65 | |
| 70.35 ³ ₀ .0635.4 | BAS GOT GG 6 M25 M20 A 4 | KV mit Zugentlastung, IP54 /CG with strain relief, IP54 | |
| 70.35 ³ ₀ .0635.3 | BAS GOT GG 6 M25 M20 A 3 | KV mit Zugentlastung und Knickschutz, IP54 /CG with strain relief and bend support, IP54 | |
| 70.35 ³ ₀ .0635.2 | BAS GOT GG 6 M25 M20 A 2 | Zwischenstützen /Bushing | |
| 70.35 ³ ₀ .0635.1 | BAS GOT GG 6 M25 M20 A 1 | Gewindebohrung /Thread hole | X |
| 70.35 ³ ₀ .0635.0 | BAS GOT GG 6 M25 M20 A 0 | Kabelverschraubung(KV), IP54 /Cable gland(CG), IP54 | |
| Bestellnummer /Order number | Typ /Type | Varianten /Variants | der-gestellt /drawed |

Weitere Daten siehe KATALOG oder eKatalog. Additional data see CATALOG or eCatalog. www.wieland-electric.com eshop.wieland-electric.com

| | | | |
|---|--|---|------------------------------|
| Tolerierung Size ISO 14405/Tolerance system Size ISO 14405. (This ISO-standard describes the envelope principle. According to the envelope principle the deviations of form and parallelism are limited by the size tolerances). | | ja/yes <input checked="" type="checkbox"/> Stoffverbots- und Deklarationsliste nach UU-TOM-05/03 ist einzuhalten. Conformity with Wieland document UU-TOM-05/03 (list of prohibited / declarable hazardous substances) to be declared! | |
| Freitoleranz nach General tolerance | | CAD - Zeichnung, keine manuellen Änderungen CAD - drawing, no manual modifications allowed | 1.Verwendung: - First Use: - |
| Blatt: 1 von 1 Sheet: 1 of 1 | | Zeichnung Nr./Drawing No. Index | |
| / / | | Werkstoff/Material Aluminium beschichtet/ coated grau/ grey | |
| / Maßstab/Scale 1:2 | | 2013 Tag/Date Name gezeichnet/drawn 20.08. Treschan geprüft/checked - - Normgepr. Stand. check - - | |
| / Vol. mm ³ / Ofl./Surf. mm ² | | Ersatz für/Replacement for: - | |
| / / | | Type Benennung/Titel | |
| / / | | revos BASIC GEHAEUSEOBERTE IL | |
| Index Datum / Blatt Date / Sheet | | Baugröße 6-Kabelabgang seitlich-M20/M25 Hood size 6-cable outlet side M20/M25 | |
| Änderung/Revision | | | |

Weitergabe sowie Vervielfältigung dieses Dokuments, Verwertung und Mitteilung seines Inhalts sind verboten, soweit nicht ausdrücklich gestattet. The reproduction, distribution and utilization of this document as well as the communication of its contents to others without express authorization is prohibited.

703500635013K_2 CADW3028 Treschan 2013-09-201084806 1.000